



## EMPAC STAFF

Johannes Goebel / Director

Geoff Abbas / Director for Stage Technologies

Eric Ameres / Senior Research Engineer

S. Argeo Ascani / Associate Curator, Music

David Bebb / Senior System Administrator

Peter Bellamy / Senior Systems Programmer

Michael Bello / Video Engineer

Eric Brucker / Lead Video Engineer

Ash Bulayev / Curator, Dance + Theater

John Cook / Box Office Manager

Laura Desposito / Production Administrative Coordinator

Angel Eads / Master Electrician

Zhenelle Falk / Artist Services Coordinator

Kathleen Forde / Curator, Time-Based Arts

William Fritz / Master Carpenter

Paula Gaetano / Curatorial Assistant

Kimberly Gardner / Manager, Administrative Operations

Michele Genovesi / Guest Services Coordinator

Ian Hamelin / Project Manager

Ryan Jenkins / Event Technician

Shannon Johnson / Design Director

CathyJo Kile / Business Manager

Stephen McLaughlin / Event Technician

Jason Steven Murphy / Communications Specialist

Andrew Rarig / Graphic Designer

Candice Sherman / Business Coordinator

Avery Stempel / Front of House Manager

Jeffrey Svatek / Audio Engineer

Stephanie Tribu-Cromme / Event Technician

Todd Vos / Lead Audio Engineer

Pete Wargo / Manager, Information Systems

David Watson / Web Developer

Emily Berçir Zimmerman / Assistant Curator

ON VIEW  
EMPAC

EXHIBITION

JENNIFER + KEVIN McCOY  
INDEX

APRIL 6 – OCTOBER 13 , 2012





# INDEX

JENNIFER + KEVIN MCCOY

*Index* is a commissioned public art installation by Rensselaer arts alumni Jennifer and Kevin McCoy, which consists of multiple sculptures filmed via small, live cameras. The resulting software based video presentation, as well as the models, appear throughout EMPAC's public spaces. Over the span of the exhibition, the artists will add sculptures in various locations throughout the building.

Inspired by a J.G. Ballard short story called *The Index*, in which an alphabetized list of people and places point to global conspiracy, the McCoy's project examines the Ballardesque scenes of today, referencing globalization, technology, mass migrations, and war. Corporate campuses, film sets, Spanish Colonial Revival architecture, and factories all collide in a globalized mediated framework that exists to support utopian goals, even as it rests upon resource depletion, financial instabilities, and entropic decay. These problems of environmental and economic collapse persist in the face of the never-changing rhetoric of the assumed benefits of the technological future.

**CURATOR: KATHLEEN FORDE**

# CHECKLIST

INDEX #1-8

1. BEHIND THE HILLSIDE



2. IN FRONT OF THE SUBSTATION



5. BETWEEN THE RESORTS



6. NEAR THE COMMUNICATION TOWER



3. ALONG THE ROADSIDE



4. NEAR THE NEW VILLAS



7. NEXT TO THE PARKING LOT



8. AT THE OLD HEADQUARTERS

# MAP

LEVEL 4 + LEVEL 7

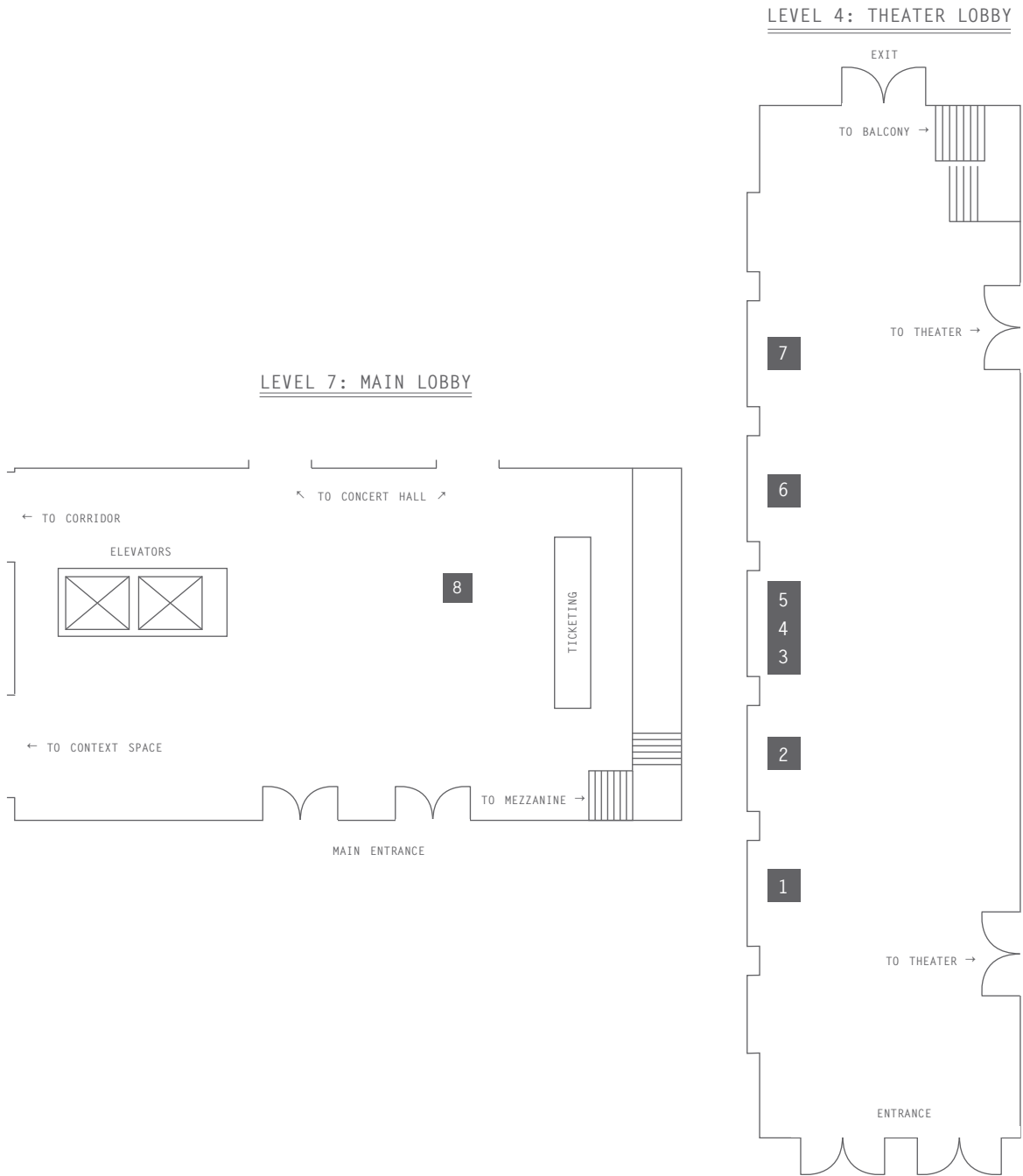

## ABOUT THE ARTISTS

Jennifer and Kevin McCoy's multimedia artworks examine the genres and conventions of filmmaking, memory, and language. They are known for constructing subjective databases of existing material and making fragmentary miniature film sets with lights, video cameras, and moving sculptural elements to create live cinematic events. Recent projects extend this work to autobiographical and political themes. They are the 2011 recipients of a Guggenheim Fellowship and were the 2005 recipients of the Wired Rave Award for Art. The McCoy's work has been widely exhibited in the US and internationally—their most recent shows include z33 in Hasselt, Belgium, the Museum of Modern Art in New York, the British Film Institute Southbank in London, Hannover Kunstverein, the Beall Center in Irvine, CA, PKM Gallery in Beijing, the San Jose Museum of Art, Palazzo delle Papesse, the Addison Gallery of American Art, the Nevada Museum of Art, and Artists Space in New York. Their work can be seen in the collections of the Museum of Modern Art, the Metropolitan Museum of Art, the Milwaukee Art Museum, and the 12c Museum in Louisville, KY. The McCoy's are 1994 alumni of Rensselaer's MFA program in electronic arts. They live in New York City.

## ABOUT EMPAC

The Curtis R. Priem Experimental Media and Performing Arts Center (EMPAC), founded by Rensselaer Polytechnic Institute, is an international hub for art, performance, science, and technology—offering adventurous interdisciplinary public events, support for artists and scholars engaged in creative research, and the resources of a state-of-the-art facility for digital media production, research, and performance situated on a college campus.

## ABOUT RENSSELAER

Rensselaer Polytechnic Institute, founded in 1824, is the nation's oldest technological university. The school offers degrees in engineering, the sciences, information technology, architecture, management, and the social sciences and humanities. For over 30 years, the Institute has been a leader in interdisciplinary creative research, especially in the electronic arts. In addition to its MFA and PhD programs in electronic arts, Rensselaer offers bachelor's degrees in electronic arts, and in electronic media, arts, and communication—one of the first undergraduate programs of its kind in the United States. The Center for Biotechnology and Interdisciplinary Studies and EMPAC are two major research platforms that Rensselaer established at the beginning of the twenty-first century.

## FUNDING INFORMATION

EMPAC 2011-2012 presentations, residencies, research, and commissions are supported by grants from the National Endowment for the Arts, the National Science Foundation, the National Dance Project of the New England Foundation for the Arts (with lead funding from the Doris Duke Charitable Foundation; additional funding from the Andrew W. Mellon Foundation, the Community Connections Fund of the MetLife Foundation, and the Boeing Company Charitable Trust), and the New York State Council for the Arts. Special thanks to the Jaffe Fund for Experimental Media and Performing Arts for support of artist commissions.



Photography: Kris Qua